



**FOUR WHEEL**  
POP-UP CAMPERS

# Keystone Model



Dry Weight: 1050 Lbs.  
Height Down (including vent): 59"  
Roof Length: 156"  
Floor Length: 108"  
Body Width: 80"

Adult Sleeping: 3-4  
Extended Interior Height: 6'6"  
Roof/Wall Framing: Aluminum  
Exterior Material: Aluminum  
Fresh Water Capacity: 22 Gallons

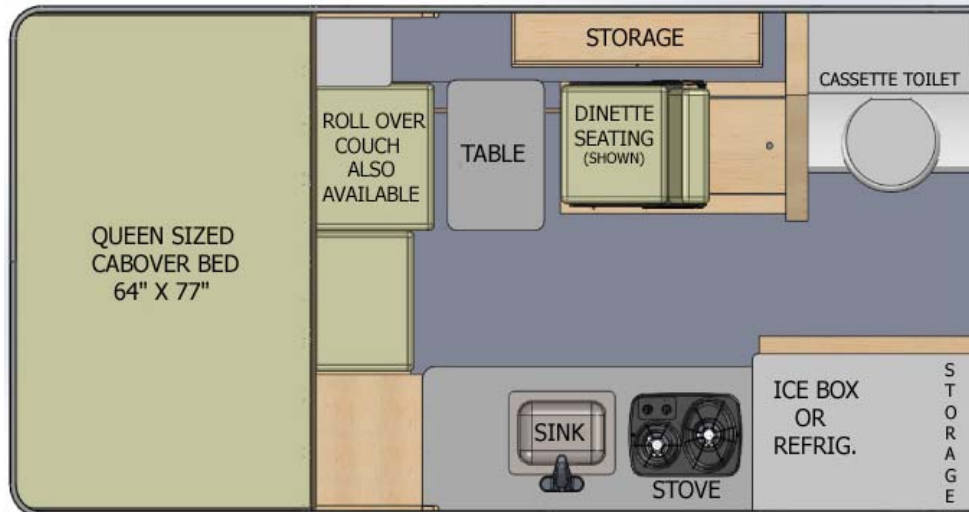

**Northern California Factory & Showroom**

**109 Pioneer Avenue, Woodland, CA 95776**

**(800) 242-1442 or (530) 666-1442 WWW.FOURWH.COM**



### **Available Options:**

Mechanical Camper Jacks w/ Brackets (4 corner)  
 Jack Brackets Only (steel brackets)  
 Jack Brackets Only (aluminum brackets)  
 Swing-Out Brackets  
 Aluminum Jack Extension Plates  
 Smooth Fiberglass Exterior Siding (instead of aluminum)  
 3-Way Refrigerator Only 1.9 cu.ft. (AC/DC/Propane)  
 3-Way Refrigerator / Freezer 3.0 cu.ft. (AC/DC/Propane)  
 Waeco Compressor 110 Liter Refrigerator/Freezer (AC/DC)  
 Waeco Compressor 80 Liter Refrigerator/Freezer (AC/DC)  
 Waeco Compressor 65 Liter Refrigerator/Freezer (AC/DC)  
 Refrigerator Vent Fan (for better cooling)  
 Forced Air Furnace w/ Thermostat  
 Flush Mount Glass Top Appliances (sink & stove)  
 Hot Water / Outside Shower Package  
 DSI (electric start for the hot water heater)  
 Stereo System (AM/FM/CD/2 Speakers)  
 Power Roof Vent Fan (Fan-Tastic Vent Fan)  
 Extra Roof Vent  
 Midi Heki Skylight  
 Screen Door  
 Front Opening Window  
 Front Opening Window Boot  
 8' Side Awning  
 Auxiliary Side Awning Light  
 Rear Awning  
 Aluminum Boat / Luggage Roof Rack  
 Yakima Roof Rack Systems or Yakima Tracks Only  
 Rear Wall Steps (better access to the roof)  
 Rear Wall Bike Rack  
 85 Watt Solar Panel w/ Charge Controller  
 Solar Panel Wiring "PLUG ONLY" on Roof or Side of Camper  
 Fluorescent Interior Lights (upgrade)  
 LED Interior Lights (upgrade)  
 Interior Flexible HELLA Reading Light (passenger side wall)  
 Rear Flood Lights (Halogen or LED)  
 LED Exterior Lighting Package  
 Arctic Pack (Cold Weather Insulation)  
 Aux. Battery System (wiring, separator, battery)  
 Accessory Cabinet w/ Additional Outlets  
 Small Driver's Side Window  
 Roof Lift Assist (Gas Struts or Hand Crank Available)  
 Plastic Rubbermaid Portable Entry Step  
 Ready To Go Anywhere Starter Package

### **Standard Features:**

All Aluminum "Flex-Frame"  
 Extended Cabover Bed  
 Finished Wood Interior  
 3 Piece Portable Dining Table  
 Formica Counter Tops  
 Deluxe Fabric Cushions  
 Privacy Curtains  
 Stainless Steel Kitchen Sink w/ Electric Water Pump  
 2 Burner Propane Stove w/ Cover  
 Ice Box or Storage Cabinet  
 110V System w/ 30 amp Power Converter  
 Two Overhead Dual Lamp 12V Lights  
 12V Porch Light  
 2 (two) 10 lb. Propane Tanks  
 Fire Extinguisher  
 22 Gallon Fresh Water Tank  
 Roll Over Couch or Dinette Seating  
 Large Radius Louvered Passenger Side Window  
 Safety Exit  
 Roof Vent  
 Insulated Side Walls & Roof  
 Rugged Vinyl Side Liner  
 Aluminum Exterior Sides and One Piece Roof



**Northern California Factory & Showroom**  
**109 Pioneer Avenue, Woodland, CA 95776**  
**(800) 242-1442 or (530) 666-1442 WWW.FOURWH.COM**